

## Product Information

BKT RJ45 side clamp

Card No.: PI\_1133A230\_01.20

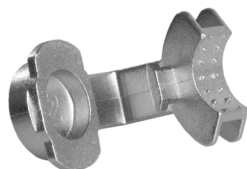

## Application

The BKT RJ45 side clamp enables attach the cable to the BKT RJ45 keystone module when the cable is inserted from one of its sides. This solution can be used in shallow wiring channels and floor boxes, where traditional cable entry is not possible due to the limited depth.

## Features

- Possibility to enter cable from left/right side of BKT RJ45 keystone module
- The cable can be attached with a cable tie
- Metal construction to ensures screen continuity in screened links
- The product is sold in 25 pcs package
- Cable ties included

## Standards

- RoHS 2011/65/EU



## Performance / Variants

Index	Product description
1133A230	BKT RJ45 Side clamp (25 pcs)